

Fisher-Price®

W1443

made by
ME!  **™**



Please keep this instruction sheet for future reference,
as it contains important information.

Adult setup is required.

www.fisher-price.com

Important Information

- Adult supervision is recommended.
- Paints may stain some surfaces. Protect the play area before use.
- Water toys sometimes get messy. Do not play with this toy on surfaces that can be damaged by water.
- Keep paint away from eyes.
- After each use, drain and rinse this toy. Dry thoroughly before storing.
- If paint gets on skin, wash with soap and water. Wash hands with soap and water after use.
- Avoid contact with finished and unfinished wood, matte finish paint, wallpaper, painted walls, carpeting and other material that cannot be washed or laundered.
- If paint gets on clothing, pretreat with a stain remover and wash separately in warm water as soon as possible. A second washing may be necessary to remove paint.

Includes

4 No Spill
Paint Cups

4 Tempera
Paints

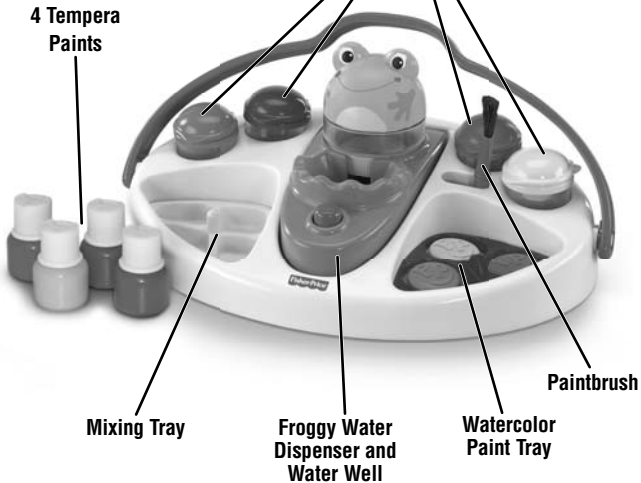



CONSUMER ASSISTANCE

1-800-432-5437 (US & Canada)

1300 135 312 (Australia)

 service.fisher-price.com

Fisher-Price, Inc., 636 Girard Avenue, East Aurora, NY 14052.

Hearing-impaired consumers: 1-800-382-7470.

Outside the United States:

Canada: Mattel Canada Inc., 6155 Freemont Blvd.,
Mississauga, Ontario L5R 3W2; www.service.mattel.com.

Great Britain: Mattel UK Ltd, Vanwall Business Park,
Maidenhead SL6 4UB. Helpline: 01628 500303.
www.service.mattel.com/uk

Mattel Europa, B.V., Gondel 1, 1186 MJ Amstelveen, Nederland.

Australia: Mattel Australia Pty. Ltd., 658 Church Street,
Locked Bag #870, Richmond, Victoria 3121 Australia.

New Zealand: 16-18 William Pickering Drive,
Albany 1331, Auckland.



Fisher-Price, Inc., a subsidiary of Mattel, Inc., East Aurora, NY 14052 U.S.A.
©2011 Mattel, Inc. All Right Reserved. © and ™ designate U.S. trademarks of Mattel, Inc.

PRINTED IN CHINA

W1443pr-0920

Setup



- Twist to remove the cap from the paint bottle. Remove and discard the seal on the paint bottle, then replace the cap.
- Fill the no-spill paint cups with paint.

Note: To prevent paints from drying out, empty paint from the no-spill cups after each use.

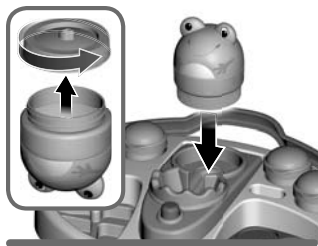

- Twist to remove the cap from the froggy water dispenser. Fill with water to the fill line and replace the cap.
- Fit the dispenser into the base.

Well



- The well will automatically fill with clean water.

Setup

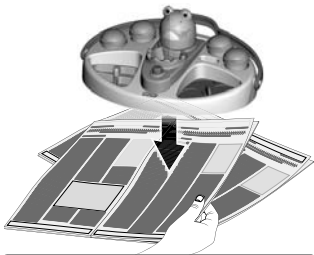

- Place newspaper or another protective material on your work surface.

Painting Fun!



- Use the mixing tray to mix paint colors. Dip your brush in the well to clean or for use with watercolors.



- Press the button to drain dirty water from the well.

Cleanup

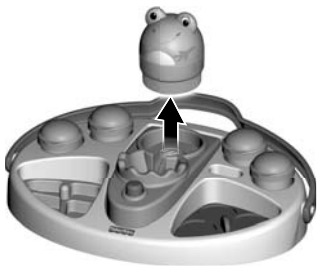

-
- Remove the froggy water dispenser from the well.

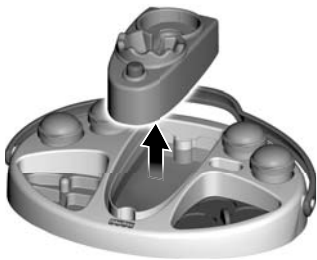

-
- Lift to remove the top of the well from the tray.

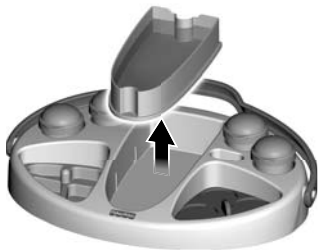

-
- Carefully remove the bottom of the well from the tray and pour dirty water out. Rinse and replace in the base.
 - Clean the froggy water dispenser and water well, no-spill paint cups, paintbrush, mixing tray and base with a mild soap and water solution.

All-in-One Storage



- When finished, replace the no-spill paint cups and the paintbrush in the base.